

Plastic Modular Belt

Series **uni Flex L-OSB** Type **65% Open (Radius 1.6)**

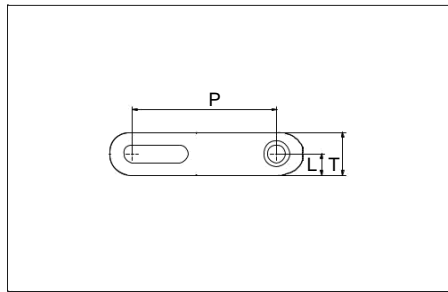

Sideflexing belt
 Nominal pitch: 50.8 mm (2.00 in)
 Surface type: Open
 Surface opening: 65%
 Backflex radius: 65.0 mm (2,56 in)
 Pin diameter: 6.0 mm (0.24 in)
 Min. inside radius: R1.6 x belt width

Belt material & color	POM-D	PP		mm	in		mm	in
			P (Nominal)	50.8	2.00	T	15.0	0.59
Pin and lock material & color	PA6.6		L	7.5	0.29	-	-	-

Non standard material and color: See uni Material and Color Overview.
 Alternative pin and lock systems and materials: Contact Customer Service.

Belt width		Permissible tensile force (Belt/pin material)								Belt weight (Belt/pin material)				*Min. No. drive sprocket per shaft	Number of wear strips (Min. No.)	
		POM-D/PA6.6				PP/PA6.6				POM-D/PA6.6		PP/PA6.6			**Carry (pcs)	**Return (pcs)
		Straight sections		Curve sections		Straight sections		Curve sections		kg/m	lb/ft	kg/m	lb/ft			
mm	in	N	lbf	N	lbf	N	lbf	N	lbf	kg/m	lb/ft	kg/m	lb/ft			
608	23.9	8579	1929	2500	562	6572	1477	1600	360	3.9	2.63	2.9	1.94	5	5	3
659	25.9	9110	2048	2500	562	6990	1571	1600	360	4.2	2.85	3.1	2.10	5	5	3
710	28.0	9640	2167	2500	562	7408	1665	1600	360	4.6	3.07	3.4	2.26	5	5	3
761	30.0	10171	2286	2500	562	7826	1759	1600	360	4.9	3.29	3.6	2.42	7	6	3
811	31.9	10691	2403	2500	562	8236	1852	1600	360	5.2	3.51	3.8	2.58	7	6	3
862	33.9	11221	2523	2500	562	8655	1946	1600	360	5.6	3.73	4.1	2.75	7	6	3
913	35.9	11751	2642	2500	562	9073	2040	1600	360	5.9	3.95	4.3	2.91	7	7	4
964	38.0	12282	2761	2500	562	9491	2134	1600	360	6.2	4.17	4.6	3.07	7	7	4
1014	39.9	12802	2878	2500	562	9901	2226	1600	360	6.5	4.39	4.8	3.23	7	7	4
1065	41.9	13332	2997	2500	562	10319	2320	1600	360	6.9	4.61	5.0	3.39	9	8	4
1116	43.9	13863	3116	2500	562	10737	2414	1600	360	7.2	4.83	5.3	3.56	9	8	4
1167	45.9	14393	3236	2500	562	11156	2508	1600	360	7.5	5.05	5.5	3.72	9	8	4
1217	47.9	14913	3352	2500	562	11566	2600	1600	360	7.8	5.27	5.8	3.88	9	9	5
1268	49.9	15443	3472	2500	562	11984	2694	1600	360	8.2	5.49	6.0	4.04	9	9	5
1319	51.9	15974	3591	2500	562	12402	2788	1600	360	8.5	5.71	6.3	4.20	9	9	5
1370	53.9	16504	3710	2500	562	12820	2882	1600	360	8.8	5.93	6.5	4.36	11	10	5
1420	55.9	17024	3827	2500	562	13230	2974	1600	360	9.1	6.15	6.7	4.52	11	10	5
1471	57.9	17555	3946	2500	562	13648	3068	1600	360	9.5	6.37	7.0	4.69	11	10	5
1522	59.9	18085	4066	2500	562	14067	3162	1600	360	9.8	6.59	7.2	4.85	11	11	6

Additional non-standard belt widths are available upon request.
 General belt tolerance is +0/-0.4% at 23°C/73°F. For exact belt width contact Customer Service.
 *Max. Load per Drive Sprocket. Belt material: POM-D 1000 N (225 lbf), PP 550 N (123 lbf).
 **Max. Spacing between wear strips, Carry: 152.0 mm (6.00 in); return: 304.0 mm (12.00 in).
 Belt needs support rollers or flanged rollers at each belt edge for support.



STANDARD

FLEXING

SIDE

PITCH 50.8 MM/2.00 IN

Accessories

Side Guard Closed

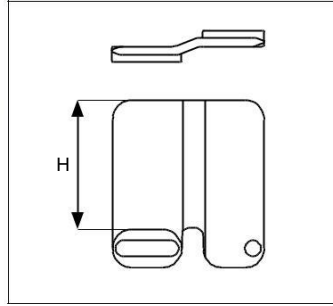
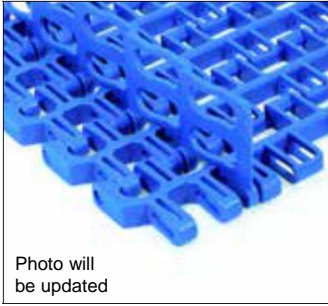

Side Guard Open

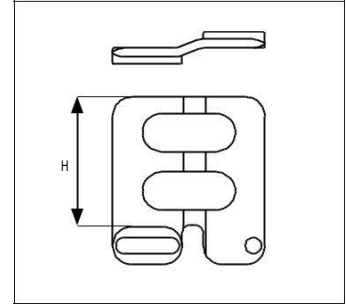
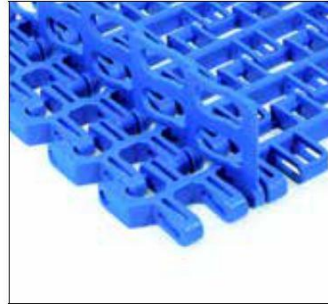

Side Guard Outside Closed

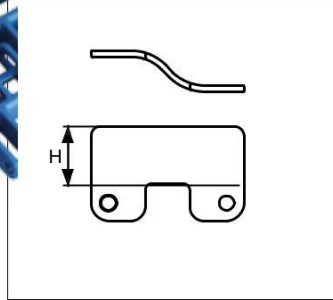
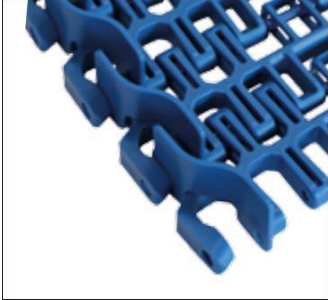

Side Guard Snap-On Closed

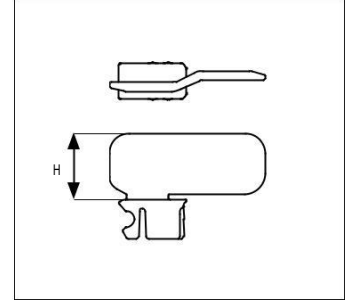
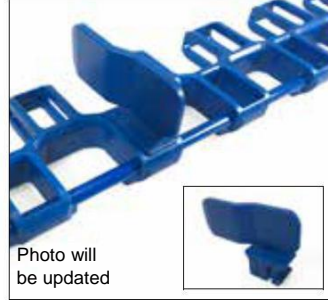

Type	Material & color	H	
		mm	in
Side Guard Closed	POM-D B	10.0	0.39
		25.4	1.00
		50.0	1.97
Side Guard Open		50.0	1.97
Side Guard Outside Closed		25.4	1.00
Side Guard Snap-On Closed	25.4	1.00	

Indent for Side Guard Closed and Side Guard Open: 55.0 mm (2.17 in) or 80.0 mm (3.15 in).

Min/max indent for Side Guard Outside Closed: 10.0 mm (0.39 in).

Min indent for Side Guard Snap-On Closed: 175.0 mm (6.89 in) and Increment 50.8 mm (2.00 in).

Non Standard material and color: See uni Material and Color Overview.

Design Guidelines

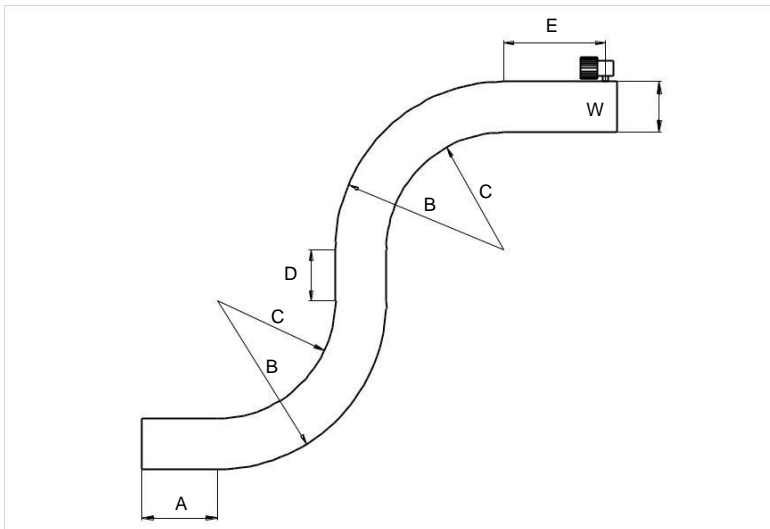

uni Flex L-OSB 65% Open Radius 1.6	
A	min. 1.5 x W
B	min 2.6 x W
C	min 1.6 x W
D	min 2.0 x W
E	min 2.0 x W, min.
W	Belt width

Sprocket

No. of teeth	Bore size							mm		in		mm		in		mm		in		Dimension		Sintered way	Machined N
	Pilot Bore	mm	in	001.25.4	030.181.	251.31.8	501.38.1	040.571.	502.63.5	diameter	diameter	diameter	diameter	diameter	diameter	A	mm	B	in				
	mm	in	mm	in	mm	in	mm	in	mm	in	mm	in	mm	in	mm	in	mm	in					
Z08	✓			●	●					134.6	5.30	131.5	5.18	107.6	4.23	54.4	2.15	74.9	2.95	✓	■		
Z10	✓			●	●	●				168.3	6.63	164.0	6.46	141.3	5.56	71.4	2.81	90.8	3.57	✓	■		
Z12	✓			●		●	●	●	■	203.5	8.01	196.5	7.74	176.5	6.94	88.2	3.47	106.8	4.20	✓	■		
Z15	✓			●		●	●	●	■	253.4	9.98	245.4	9.66	226.4	8.91	113.2	4.46	131.0	5.16	✓	■		

■ Machined sprocket

● Machined sprocket

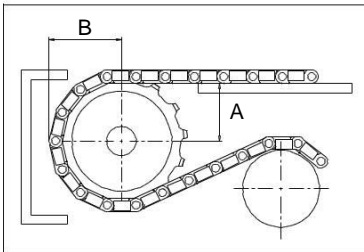
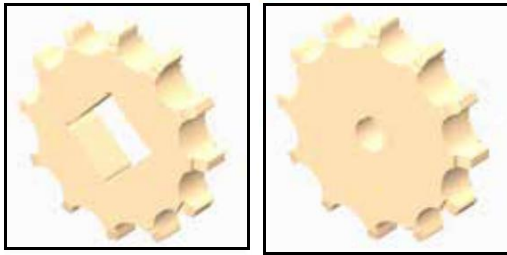

Non standard material and color: See uni Material and Color Overview.

Other sprocket sizes are available upon request

Two-part sprocket are available upon request

Other bore sizes are available upon request

uni Retainer Rings: See uni Retainer Ring data sheet

Width of tooth = 30.0 mm (1.18 in)

Width of sprocket = 40.0 mm (1.57 in)

Max. load per sprocket shown does not take bore size into account.

Please also ensure that sufficient size shaft is chosen for corresponding load.

For correct sprocket position: See uni Assembly Instructions for uni Flex L-OSB.

For more detailed sprocket information, contact Customer Service.